

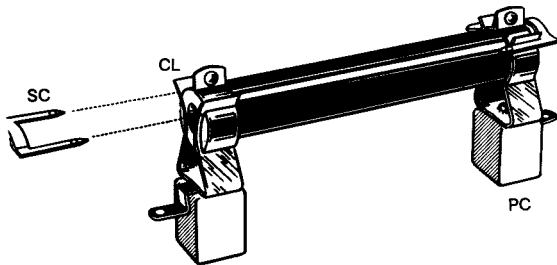

CL-SC PC

mounting accessories for wirewound resistors

– equipped with B bands
suitable for RW - RA Series



These flexible clips, of special alloy, provide effective protection against corrosion and extreme working temperature. The stainless steel clip-tightener SC increases fixing stability and improves electrical contact.

The PC clip-holders are ceramic blocks drilled with 3 threaded holes and guarantee an insulation voltage greater than 10,000 V RMS. They can be fitted with 6 types of clip and are supplied unassembled, with a packet containing connecting lugs, screws, washers and rubber wedges. Unit weight is approximately 60 g.

CL Clips

Table 1

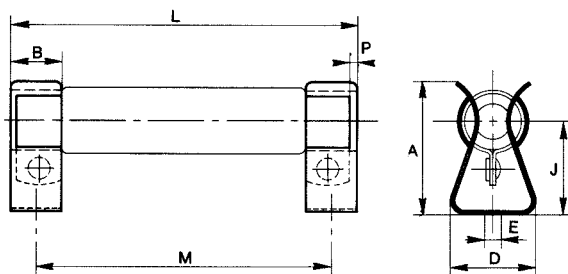

| Series | Style | Type | A | B ±0,5 | D | E ±0,2 | J ±1 | L -0 -4 | M -0 -4 | P ±0,3 | Weight in g. |
|----------|--------|-------|----|-----------|----|-----------|---------|---------------|---------------|-----------|-----------------|
| RW | 10x50 | CL 10 | 25 | 10,5 | 16 | 4,2 | 18 | 57 | 46,5 | 2,6 | 5 |
| RA RW | 13x70 | CL 13 | 30 | 12,5 | 18 | 4,2 | 24 | 76 | 63,5 | 2 | 6 |
| RA RW | 16x94 | CL 16 | 36 | 14 | 23 | 4,2 | 25 | 101 | 87 | 2,5 | 10 |
| RA RW | 20x117 | CL 20 | 43 | 16 | 27 | 4,2 | 28 | 123 | 107 | 2 | 13 |
| RA | 25x138 | CL 25 | 46 | 17 | 32 | 4,2 | 32 | 144 | 127 | 2 | 20 |
| RA | 25x168 | CL 25 | 46 | 17 | 32 | 4,2 | 32 | 174 | 157 | 2 | 20 |
| RA | 30x250 | CL 30 | 51 | 20 | 38 | 5,2 | 38 | 258 | 238 | 2,5 | 25 |

SC Clip-Tighteners

Table 2

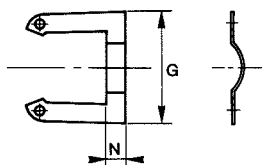

| Series | Style | Type | G | N±0,2 | Weight in g |
|----------|--------|------|--------|-------|-------------|
| RW | 10x50 | SC10 | 18±1 | 4 | 0,6 |
| RA RW | 13x70 | SC13 | 25±1 | 5 | 1,2 |
| RA RW | 16x94 | SC16 | 25±1 | 5 | 1,2 |
| RA RW | 20x117 | SG20 | 29±1 | 5,5 | 1,5 |
| RA | 25x138 | SC25 | 35±1,5 | 6 | 2,2 |
| RA | 25x168 | SC25 | 35±1,5 | 6 | 2,2 |
| RA | 30x250 | SC30 | 41±1,5 | 7 | 3,5 |

PC Clip-Holders

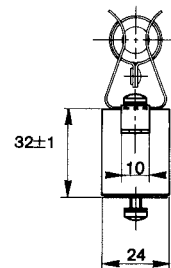
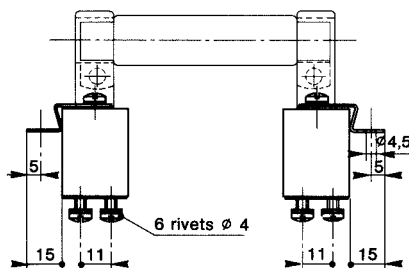

Dimensions in mm

ORDERING PROCEDURE

For special "electrical traction" resistors (SNCF), quote:

CL: BB1

PC: BA9

MODEL

CLIP

CLIP

CLIP

TYPE

CL10

SC20

PC

NUMBER OF PAIRS

...

Note: clips are sold in pairs